



# ESD8

## User Guide

---



## Content

<b>ESD8</b>	<b>4</b>
Overview	4
Installation, Drawings	5
Frequency characteristics	6
Specifications	7
<b>Accessories</b>	<b>8 - 9</b>
<b>Warranty · Service</b>	<b>10</b>

## ESD8 FULL RANGE 8 Ohms

ESD8 - part number KVV 987 423



### Application

Purpose designed as a discreet portable passive loudspeaker for speech and music content

- Corporate presentations and functions
- Full range performance with addition of subwoofers
- Infills
- Close monitoring
- Fixed installations

### Introduction

The ESD8 is a compact passive 2-way, high output full-range loudspeaker incorporating an 8" trans-coil woofer and a 1" compression driver coupled to a wide dispersion horn. Presented conservatively in a unique angled low-profile Baltic birch enclosure and designed to present exceptional speech and music definition, the ESD8 provides a smooth hi fidelity response and delivers a natural sound quality and level that is superior to many larger competing products. Ideal as a main system speaker or as an in-fill for larger systems, the flexible ESD8 can be applied quickly and efficiently on podiums, stands or suspended.

### Connection

The ESD8 features both Speakon (NL4) connectors and a terminal block. The connectors are interconnected in parallel to allow the "daisy chaining" of additional ESD8's.

PARALLEL CONNECTION OF THE ESD8 (8Ω) - TOTAL IMPEDANCE 2Ω

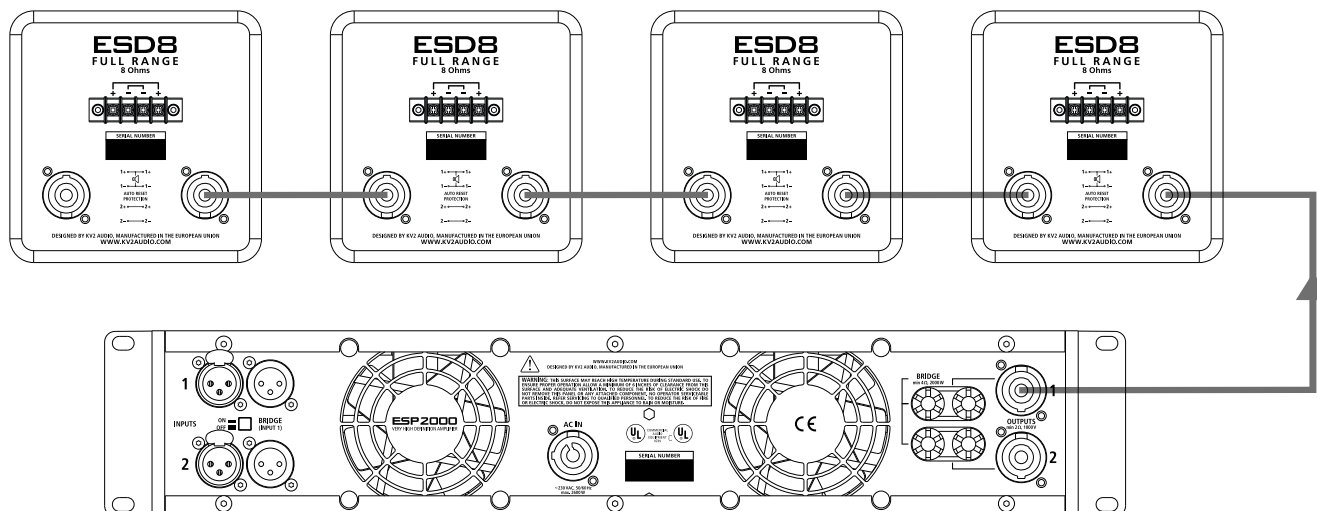

## Installation

Installations should be carried out using KV2 Audio's horizontal or vertical U brackets. They are mounted vertically using M10 points located on the side of the cabinet or in the top handle and bottom M10 plate (supplied with horizontal bracket) for horizontal fixing and to a mounting post with a diameter of 35 mm using a support flange.

The ESD8 also features a 35 mm speaker pole mount adapter housed at the bottom of the cabinet for use with conventional speaker stands and poles.

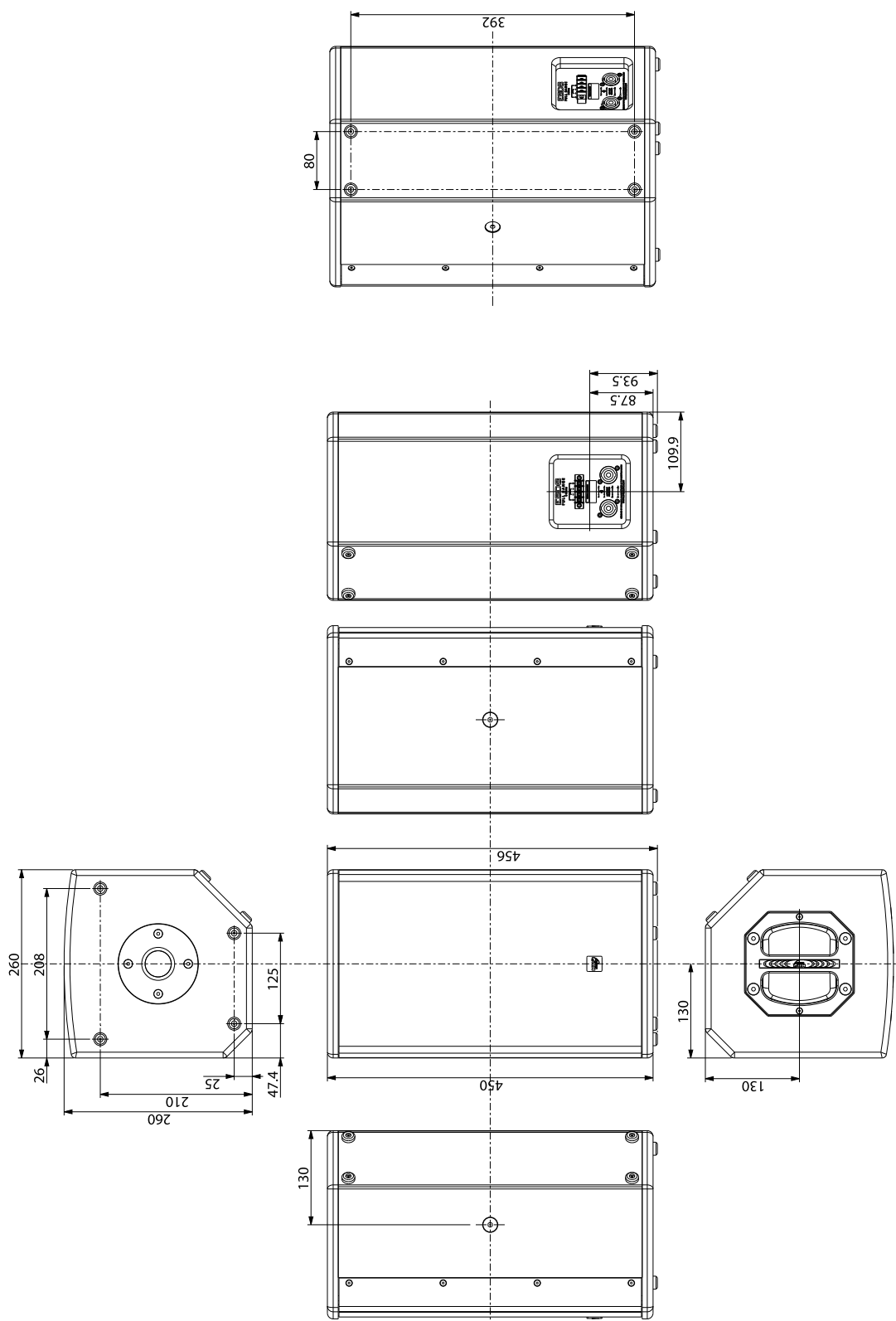

## Frequency response

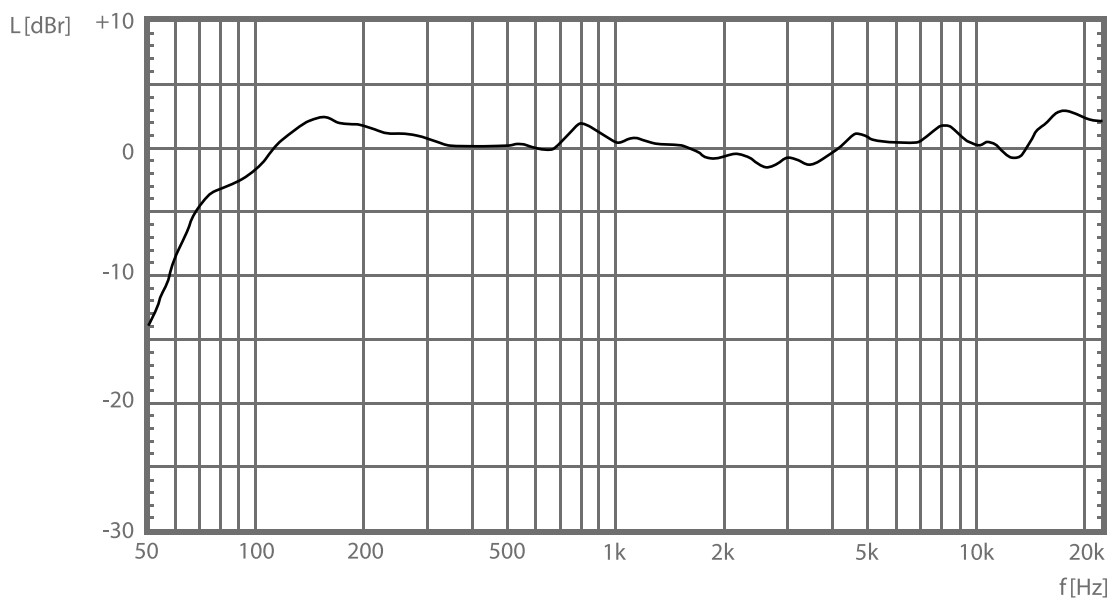

## Horizontal Polarplots

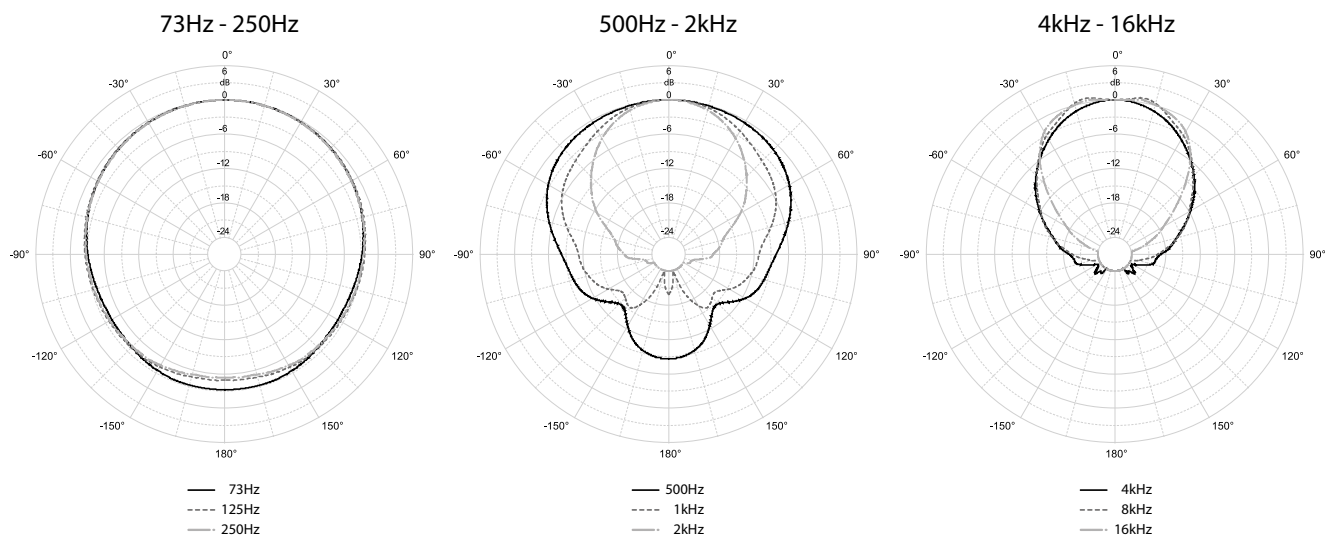

## Vertical Polarplots

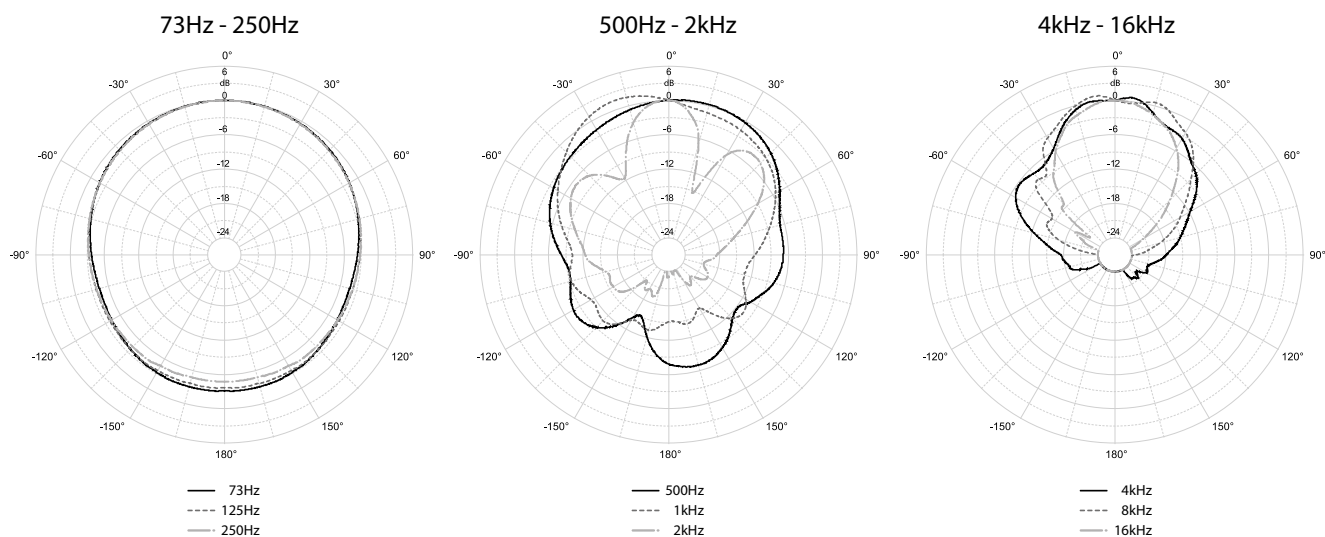

## Specifications

### System Acoustic Performance

Max SPL Long-term	121dB
Max SPL Peak	124dB
-3dB Response	80Hz to 20kHz
-10dB Response	62Hz to 28kHz
Recommended Power	275W
Sensitivity	94dB
Impedance	8Ω
Crossover Point	2.2kHz

### High Frequency Section

Acoustic Design	Horn Loaded
High Horn Coverage Horizontal / Vertical	100° x 100°
Rotatable Horn	Symmetric
Throat Exit Diameter / Diaphragm Size	1" / 1.75"
Diaphragm Material	Titanium
Magnet Type	Neodymium
Protection	RMS Limiter

### Low Frequency Section

Acoustic Design	Front Loaded, Bass Reflex
Number of Drivers	1
Woofer Size / Voice Coil Diameter / Design	8" / 2" / Trans coil
Diaphragm Material	Epoxy Reinforced Cellulose
Magnet Type	Neodymium
Protection	Thermal breaker - auto reset

### Speaker Input

Speaker Input	2x Neutrik Speakon®, Terminal Block
---------------	-------------------------------------

### Cabinet

Cabinet Material	Baltic birch
Handles	1
Color	"Orange peeled" Matt Black or any RAL

### Physical Dimensions

Height	456 mm (17.95")
Width	260 mm (10.23")
Depth	260 mm (10.23")
Weight	13 kg (28.6lbs)

## HORIZONTAL BRACKET

### Horizontal Bracket for ESD8

part name:

**ESD8 Horizontal Bracket**

part number:

**KVV 987 422**

**description:**

- black
- including two connection bolts and bracket

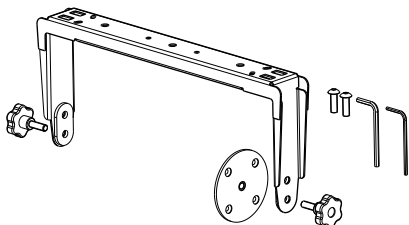

## VERTICAL BRACKET

### Vertical Bracket for ESD8

part name:

**ESD8 Vertical Bracket**

part number:

**KVV 987 421**

**description:**

- black
- including two connection bolts

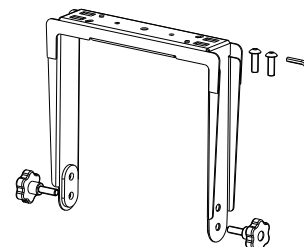

## Bracket Top Hat Adapter

part name:

**Top Hat Adapter**

part number:

**KVV 987 090**

**description:**

- for vertical and horizontal brackets
- including bolts
- black

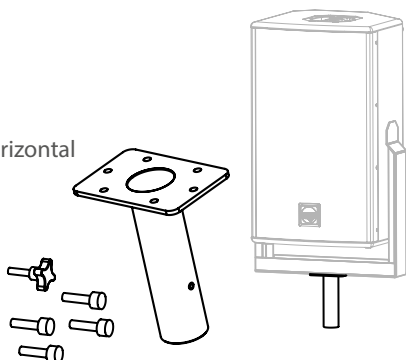

## Speaker pole - universal

part name:

**KV2-H**

part number:

**KVV 987 292**

**description:**

- Heavy duty telescopic speakerpole
- 0,735 to 1,23 m
- diameter 35 mm
- weight 2,2 kg
- max. load 50 kg
- bottom terminal M20
- matte black



## Speakon speaker cable 4.15

part name:

**CABLE SPEAKON 4.15**

part number:

**KVV 987 326**

**description:**

- 4 wire speaker cable
- Speakon NL4 connectors
- 1,5m (5ft)



## Speakon speaker cable 4.40

part name:

**CABLE SPEAKON 4.40**

part number:

**KVV 987 327**

**description:**

- 4 wire speaker cable
- Speakon NL4 connectors
- 4m (13ft)



## Speaker cables

part name:  
**1m - round flexible speaker cable,  
cross section 2 x 1.5mm**  
part number:  
**WX 002**

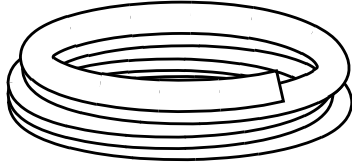

part name:  
**1m - round flexible speaker cable,  
cross section 4 x 2.5mm**  
part number:  
**WX 003**

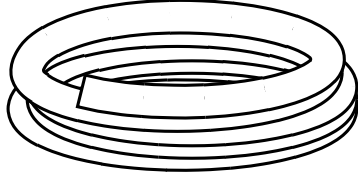

part name:  
**SPEAKON NL4**  
part number:  
**KA 027**

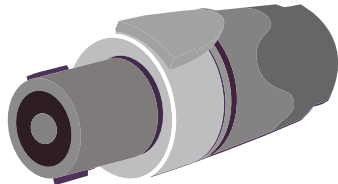

part name:  
**ESD, Speakon NL4 wiring**

positive pin  
(1 +, 2 + parallel)  
negative pin  
(1 -, 2 - parallel)

Speakon NL4 wiring

1+ — 1+



1- — 1-

2+ — 2+

2- — 2-

## Recommended maximum speaker cable length

MINIMUM CROSS SECTION [mm <sup>2</sup> ]	LENGTH [m], impedance 4Ω	LENGTH [m], impedance 8Ω	LENGTH [m], impedance 16Ω
1.5	8	15	30
2.5	15	30	60
2 x 2.5	20	40	90
4	25	50	100



## Warranty

Your ESD8 is covered against defects in material and workmanship.

Refer to your supplier for more details.

## Service

In the unlikely event that your product develops a problem, it must be returned to an authorized distributor, service centre or shipped directly to the KV2 Audio factory. Because of the complexity of the design and the risk of electrical shock, all repairs must be attempted only by qualified technical personnel.

If the unit needs to be shipped back to the factory, it must be sent in its original carton. If improperly packed, the unit may be damaged.

To obtain service, contact your nearest KV2 Audio Service Centre, Distributor or Dealer.



The Future of Sound.  
Made Perfectly Clear.

**KV2 Audio International**

Nádražní 936, 399 01 Milevsko  
Czech Republic

Tel.: +420 383 809 320

Email: [info@kv2audio.com](mailto:info@kv2audio.com)

[www.kv2audio.com](http://www.kv2audio.com)

KVV120159-00-01-0