

EX1.2MkII Technical Data Sheet

Introduction

The EX1.2MkII is a small single 12" active subwoofer system. Employing passive cooling the EX1.2MkII boasts output that belies its compact, low profile cabinet size, as with all KV2 Audio products. The enclosure dimensions make it ideal for discreet installations, as it can be installed either horizontally or vertically under seating and in furniture surrounds. Featuring KV2 Audio's switching amplifier technology, the EX1.2MkII delivers tight, fast and controlled bass response at very high output levels from an impressively conservative cabinet footprint.



Features

- Professional, Baltic birch construction with wear resistant polymer coating
- 124dB sustained output, 127dB peak
- 500W high efficiency, current-enhancing, switching, low frequency amplifier
- Complete on board subwoofer management including equalization, crossover filters, amplifier overdrive protection, output level and phase controls
- Excellent reproduction of bass frequencies with high transient content at high output levels
- Stereo or Mono inputs with through signal outputs and 120Hz High Pass outputs
- 12" high output, low frequency driver with 3" (75 mm) inside/outside, epoxy baked, high temperature, voice coil assembly and neodymium magnetic structure
- Two recessed top handles for simplified handling and carrying
- M20 top hat for pole mounting applications
- LED indicators for signal present, limiter, thermal condition and power ON status

Application

Specifically designed to accompany and compliment the EX6 as a true full range system

- For fixed installation
- Bars, restaurants and small entertainment projects
- Small footprint and dimensions allow placement under seating and fixtures

System Acoustic Performance	
Max SPL Long-term	124dB
Max SPL Peak	127dB
-3dB Response	38Hz to 120Hz
-10dB Response	32Hz to 120Hz
Crossover Point	120Hz

Low Frequency Section	
Acoustic Design	Twin Asymmetrical loading
Woofer Size / Voice Coil Diameter / Design	12" / 3" / Inside Outside
Magnet Type	Neodymium
Diaphragm Material	Epoxy Reinforced Cellulose

Low Frequency Amplifier Specification	
Type	High efficiency, Current-enhancing switch mode
Rated Continuous Power	500W
Distortion	<0.05%

Signal Input	
Input Sensitivity	1.0V RMS
Input Impedance	20kΩ (balanced)

Power	
Power Connector	Neutrik PowerCon®
Operating Voltage	115V / 230V
Operating Voltage Range	100 to 120V@60Hz 205 to 250V@50Hz
Recommended Amperage	6A 115V 3A 230V

Cabinet	
Cabinet Material	Baltic birch
Handles	2
Pole Mount	M20
Color	"Orange peeled" Matt Black or any RAL

Physical Dimensions	
Height	370 mm (14.57")
Width	800 mm (31.49")
Depth	400 mm (15.75")
Weight	32 kg (70.5lbs)

EX1.2MkII Technical Data Sheet

Architectural Specifications

The Loudspeaker shall be a Twin Chamber Bass Reflex design, using SLA Technology - (Super Live Audio), Amplifier power, electronic crossovers, phase alignment, equalisation and speaker protection are integrated into the EX1.2MkII's amplifier module.

The Loudspeaker enclosure shall consist of one 12" Neodymium magnet structure Low Frequency high definition woofer driver.

The cabinet enclosure shall be made from reinforced Baltic Birch Ply, with toughened impact and wear resistant paint finish.

The enclosure shall include four high impact, low friction feet on the bottom panel.

The EX1.2MkII Amplifier shall provide 500W. The EX1.2 Amplifier control panel shall feature AC power in, XLR connector audio input and output, level control potentiometer +/- 6dB, LED status light (power, limit/thermal signal input indicator). The EX1.2MkII amplifier shall have an input Impedance of 20Kohm. The input sensitivity shall be 1.0V RMS.

The EX1.2MkII shall use balanced, female XLR connectors for audio signal input, and male XLR connectors to provide through output signal.

The EX1.2MkII shall feature Left and Right stereo inputs and outputs allowing the product to be integrated into stereo systems that require one subwoofer. The EX1.2MkII shall also feature Left and Right High Pass Outputs that can be used to provide audio signal to mid-high speakers being used in conjunction with the EX1.2MkII. The high pass filter shall provide a crossover point of 120Hz. The EX1.2MkII features a phase switch that changes the phase of the high pass audio output signal.

The EX1.2MkII Amplifier shall have a Neutrik PowerCon connector for mains supply, with an operating voltage range of 100 to 120V @ 60Hz or 230 to 250V @ 50Hz. The power amplifier shall have recommended amperage of 6A @115V / 3A @230V.

Temperature controlled variable speed fan will assist internal convection cooling systems.

The system acoustic performance shall be -3dB 38Hz -120Hz. The system maximal long term SPL shall be 124dB.

The Speaker shall have dimensions of: Height 370 mm / 14.57", Width 800 mm / 31.49", Depth 400 mm / 15.75", The weight shall not exceed 32 kg (70.5lbs).

Dimensional Drawings

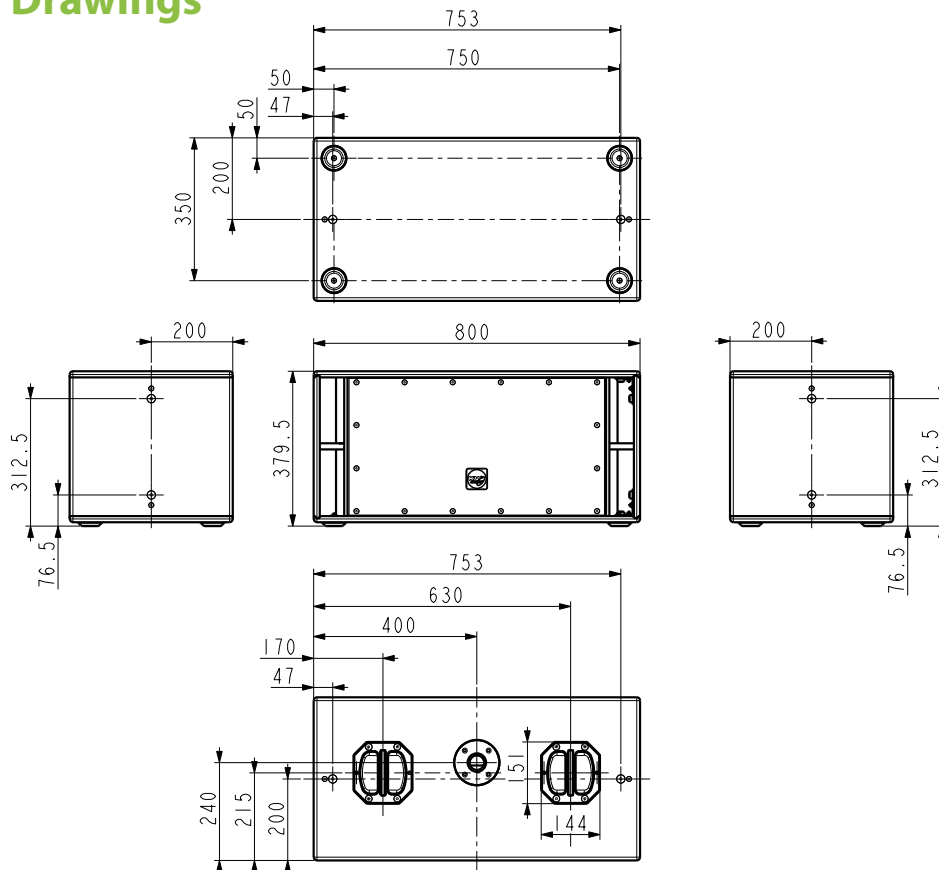

The future of sound. Made perfectly clear.



KV2 Audio International, Nádražní 936, Milevsko 399 01, Czech Republic

Tel.: +420 383 809 320

Email: info@kv2audio.com | Web: www.kv2audio.com